

RaxVision

M-65/68/81

Series Stereo Zoom Microscope



Outstanding Ergonomic Design

- ✧ M-68/81 35° viewing angle, M-65 40° viewing angle, suitable for long-term sitting observation.
- ✧ 330mm×300mm big stand, high stability , apply to all kinds of anatomy of specimen.

Top Optical & Mechanical Design

- ✧ Greenough optical system, built-in rotating shaft zoom system.
- ✧ No tilting Image in left &right light path in complete pupillary distance , No dizziness feeling after long time observing.
- ✧ (patent number: 201320807246.0)
- ✧ Stereo angle for left & right light path is 12°, stereoscopic effect, large viewing field, high zoom ration.



Excellent Technology And Quality

- ✧ High resolution, large depth of field, excellent color restoration and contrast.
- ✧ Operation comfortable(manufactured by high-precision machine, excellent assembly technology).
- ✧ High- end material(PC resin cover, aluminium alloy ,copper alloy parts, austenite stainless steel driving parts).

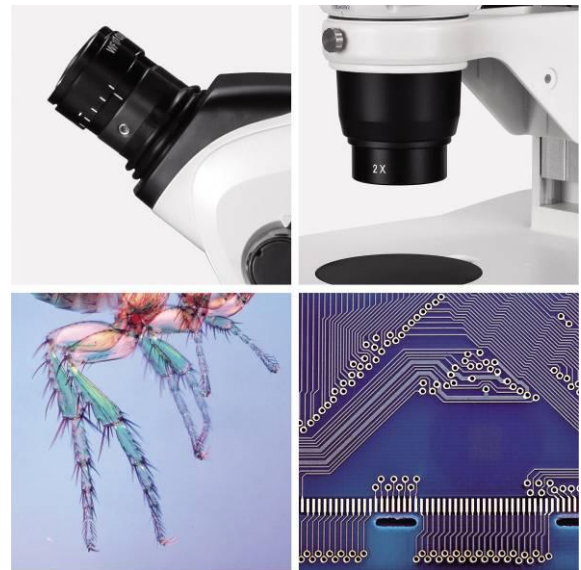

International Level Appearance Design

- ✧ Elegant shape , high-end and integrated appearance design, comfortable operation.

Various Accessories,Complete Function.

- ✧ Different video output connectors, built-in digital image model.
- ✧ Illumination optional: LED, halogen lamp, cold light source etc. (100V-240V wide voltage input).
- ✧ Various professional stands and operating attachments.

Photography System

Camera System





M-65BP



M-68/81BP



M68/81TP



M-65B2L



M-68/81B2L



M-68/81T2L



User can limit the zoom range as per self-choice.



Rotating switching to video output and input, 100% light distribution.



Pillar Stand



Focusing Arm Stand

Main Technical Specification

Model	M-65	M-68	M-81
Objectives Zoom Range	0.7X-4.5X	0.68X-4.7X	0.65X-5.3X
Zoom Ratio	1 : 6.5	1 : 6.8	1 : 8.1
Field Diameter (mm)	Φ22	Φ23	Φ24
Working Distance (mm)	110	110	110
Stereo Angle (°)	12	12	12
Viewing Angle (°)	40	35	35
Interpupillary Adjustable Distance (mm)	50-75	50-75	50-75
Video Output Distribution	NO	100% (0:100 standard)	
		50:50 optional	
Guide Rail Stand Focusing Distance (mm)	80		
Pillar Stand Focusing Distance (mm)	115		

M-65 Series Objective & Eyepiece Parameter List (0.7×-4.5×)

Additional Objective		0.5X	1X(built-in)	2X
W.D		189mm	110mm	36mm
10XEyepiece/Φ22mm	Magnification	3.5~22.5	7~45	14~90
	Field dia. (mm)	62.9~9.8	31.43~4.89	15.71~2.44
15XEyepiece/Φ16mm	Magnification	5.25~33.75	10.5~67.5	21~135
	Field dia. (mm)	45.71~7.11	22.86~3.56	11.43~1.78
20XEyepiece/Φ12mm	Magnification	7~45	14~90	28~180
	Field dia.(mm)	34.28~5.33	17.14~2.67	8.57~1.33

M-68 Series Objective & Eyepiece Parameter List (0.68×-4.7×)

Additional Objective		0.5X	1X(built-in)	2X
W.D		189mm	110mm	36mm
10XEyepiece/Φ23mm	Magnification	3.4~23.5	6.8~47	13.6~94
	Field dia. (mm)	67.65~9.79	33.82~4.89	16.91~2.46
15XEyepiece/Φ16mm	Magnification	5.1~35.25	10.2~70.5	20.4~141
	Field dia. (mm)	47.06~6.81	23.53~3.40	11.76~1.70
20XEyepiece/Φ12mm	Magnification	6.8~47	13.6~94	27.2~188
	Field dia.(mm)	35.294~5.11	17.65~2.55	8.82~1.28

M-81 Series Objective & Eyepiece Parameter List (0.65×-5.3×)

Additional Objective		0.5X	1X(built-in)	2X
W.D		189mm	110mm	36mm
10XEyepiece/Φ24mm	Magnification	3.3~25.5	6.6~51	13.2~102
	Field dia. (mm)	72.73~9.41	36.36~4.71	18.18~2.35
15XEyepiece/Φ16mm	Magnification	4.95~38.25	9.9~76.5	19.8~153
	Field dia. (mm)	48.48~6.27	24.24~3.14	12.12~1.57
20XEyepiece/Φ12mm	Magnification	6.6~51	13.2~102	26.4~204
	Field dia. (mm)	39.64~4.71	18.18~2.35	9.09~1.18

M-65/68/81 Series Zoom Stereo Microscope General Layout Diagram

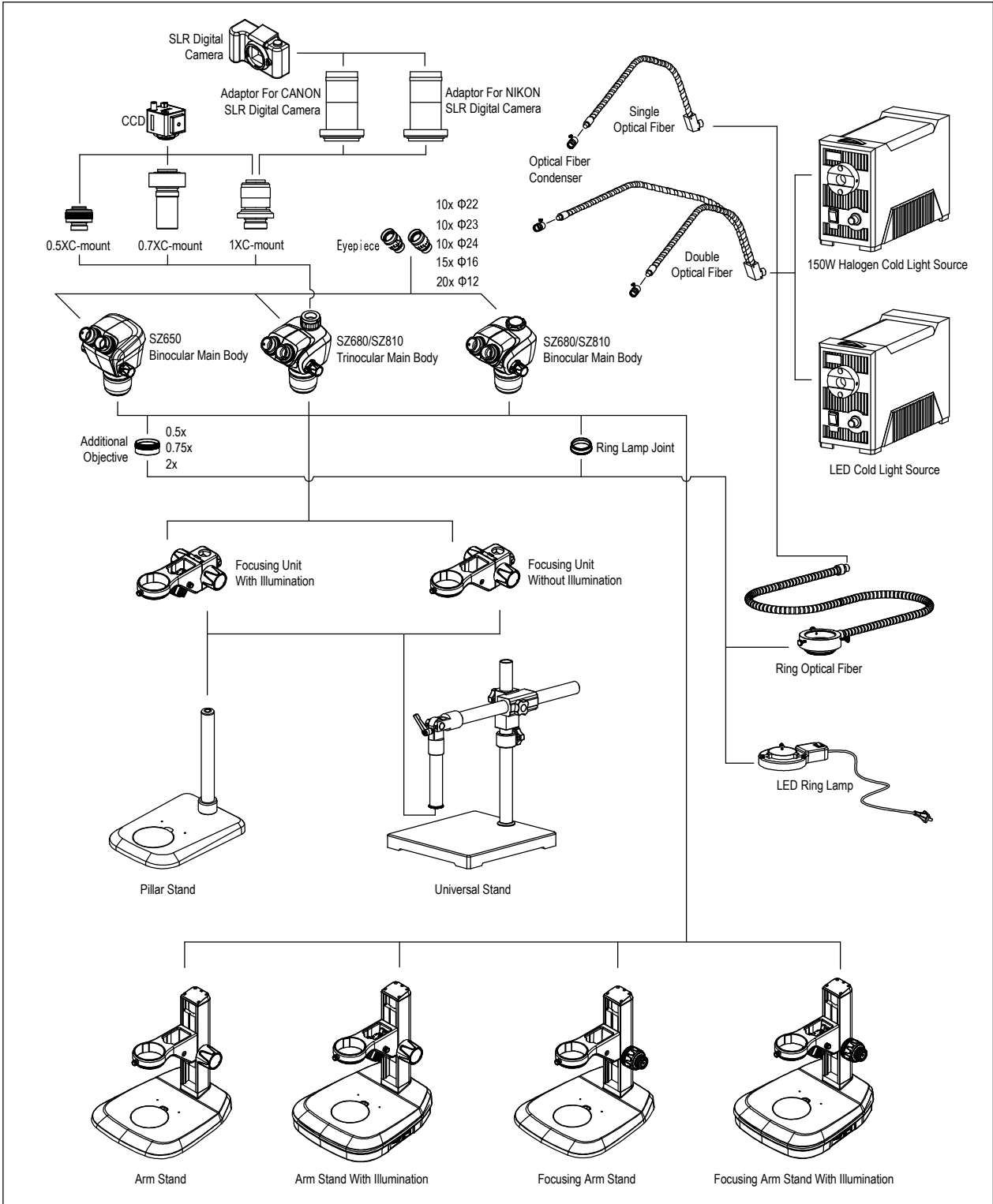

M-65/68/81 Series Zoom Stereo Microscope Outfit

Items		M-65BP	M-65B2L	M-68BP	M-68B2L	M-81BP	M-81B2L
Main Body	Binocular	●	●	●	●	●	●
	Trinocular			○	○	○	○
10XEyepiece/Φ22mm		●●	●●				
10XEyepiece/Φ23mm				●●	●●		
10XEyepiece/Φ24mm						●●	●●
15XEyepiece/Φ16 mm		○○	○○	○○	○○	○○	○○
20XEyepiece/Φ12mm		○○	○○	○○	○○	○○	○○
0.5X/0.75X/2X Objective		○	○	○	○	○	○
Focusing unit		●	●	●	●	●	●
No light		●		●		●	
Reflecting 3W LED			●		●		●
Transmitting 3W LED			●		●		●
Black & white Plate		●	●	●	●	●	●
Glass Plate			●		●		●
Arm stand		●	●	●	●	●	●
Pillar stand		○	○	○	○	○	○
Focusing Arm stand		○	○	○	○	○	○
Base (330×300mm)		●	●	●	●	●	●
C-mount 0.5X, 0.7X, 1X				○	○	○	○

Note: "●" In Table Is Standard Outfits, "○" Is Optional Accessories.

M-65/68/81 Series Zoom Stereo Microscope Size(mm)

